

# CUSTOM HOME CONCEPT



## 3 BAYWIND DRIVE

### Contact Builder for Price

At 1524 square feet with a 785 square foot three car garage the K Streu Homes newest show home offers a contemporary flair. With the condo conveniences of Pritchard Farm Southlands Village and the quality features and workmanship you expect from K Streu Homes.

The 10' ceilings and open concept along with the spacious rooms make this home ideal for entertaining. The gourmet island kitchen with walk in pantry offers quartz counter tops and two tone cabinets. The master bedroom with large walk in closet and deluxe ensuite with a custom tile shower and soaker tub.

Includes piled foundation, wood suspended basement floor, partial walk out basement, paved driveway, covered deck and oversized garage.

### DETAILS:

- 1524 square feet
- Three car garage
- Deluxe ensuite with walk in closet
- Main floor laundry/ mudroom
- Partial walk out basement
- Gas fireplace

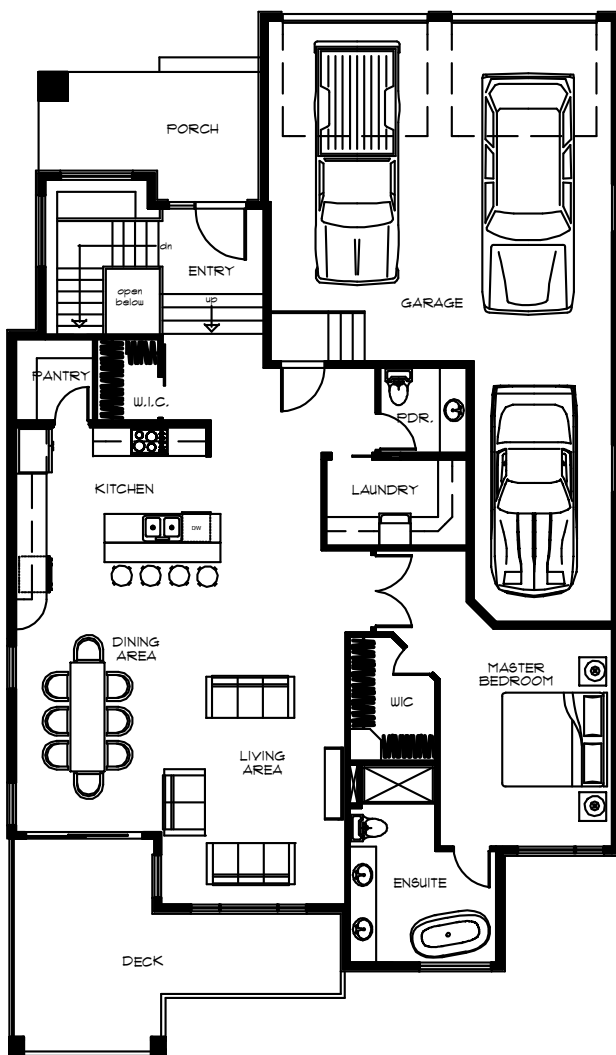

MAIN FLOOR PLAN

1524 sq. ft.



(204) 663-2170

hshstreu@gmail.com

www.kstrehomes.com